

POWER NAIL GRINDER

TP401387

Features:

- Variable speed for quick, efficient results
- Clamp-on hanging hook attaches right to your grooming table
- Grinding tip is connected to a flexible cable for easy grinding on hard-to-reach nails
- Quick-change collet for easy tip attachment

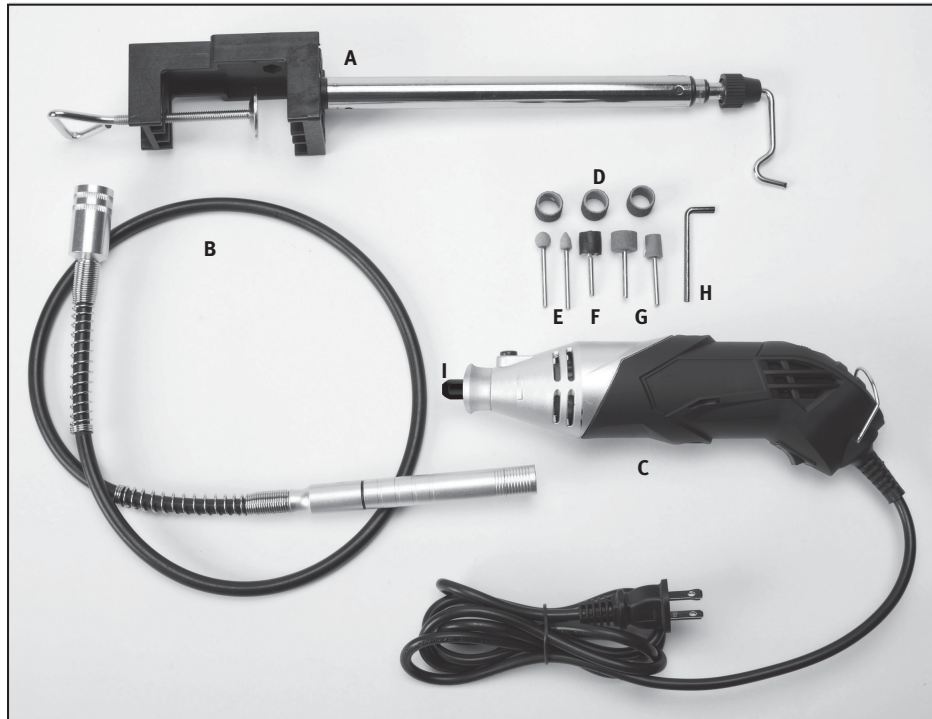

Parts:

- A.) Clamp-On Hanging Hook (1)
- B.) Flexible Cable (1)
- C.) Nail Grinder (1)
- D.) Grinding Bands (3)
- E.) Small Grinding Stones (2)
- F.) Grinding Drum (1)
- G.) Large Grinding Stones (2)
- H.) Collet Locking Key (1)
- I.) Collet (1)



Operating Instructions

1. Turn grinder on using the on/off switch at the bottom of the handle. RPM speed can be adjusted from 8,000 up to 35,000 using the dial on top of the handle.
2. Separate animal's toes by putting your thumb between the paw pads. Hold foot securely.
3. Gently run grinder on each nail using a continuous side-to-side motion.
4. Avoiding holding the grinding tip in one place to prevent over-grinding or unevenness.
5. Do not apply excessive force. Let the speed of the nail grinder do the work for you.
6. For best results on long-haired breeds, push coat hair away from pet's foot to prevent tangling and injury. To easily restrain coat, place a nylon stocking over pet's paw and push nails through loose weave to allow access to exposed nails.
7. For larger dogs, it is often easier to pull the front foot forward to grind nails. For smaller dogs, it may be easier to hold the foot up beneath the body. Be careful not to entangle hair.
8. Nails do not require trimming prior to grinding. If desired, nails can be trimmed with a guillotine or scissor-style nail trimmer prior to grinding. In this instance, the nail grinder can be used after trimming to shape and smooth out rough edges.



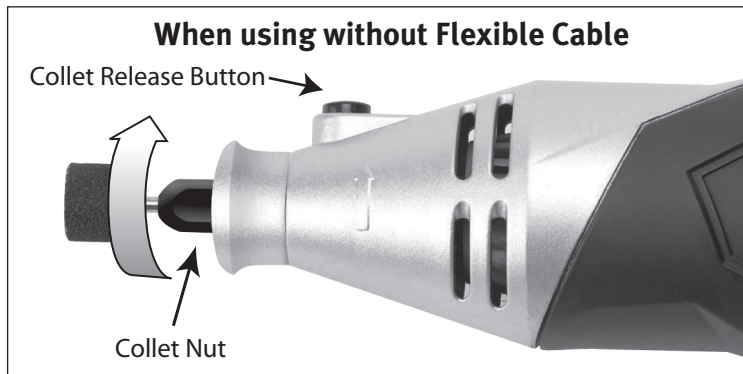
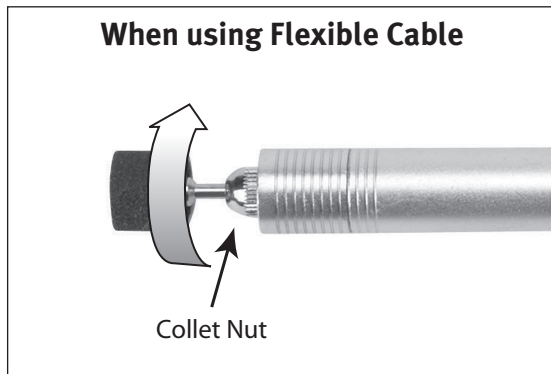
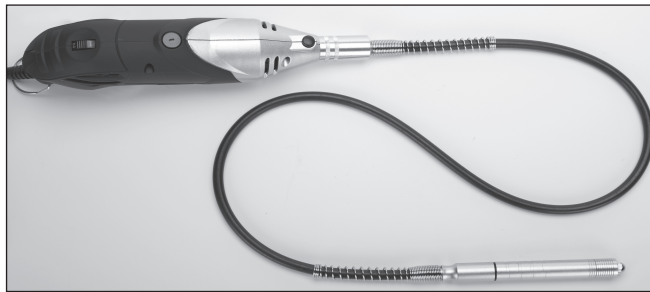
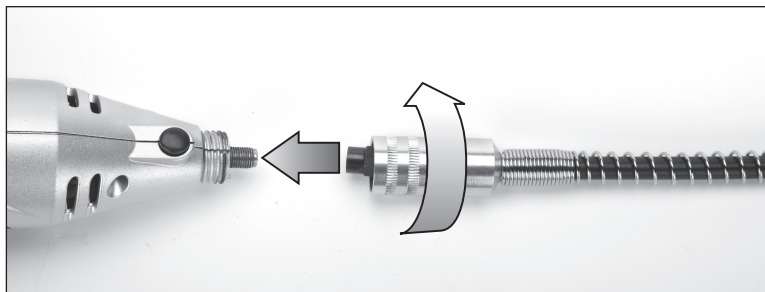

Changing Attachments:

To use grinder without flexible cable:

1. Unscrew hose attachment.
2. Remove the Collet Nut and Collet from the end of the hose attachment.
3. Slot the Collet into the grinder tip. Fit the Collet Nut over the Collet and screw into place.
4. Press the round Collet Release Button on the side of the grinder. Push the stem of the Grinding Stone or the Grinding Drum into the Collet Nut. Turn the Collet Nut until it click and release the Collet Release Button to lock the stem in place.
5. To release the stem of the Grinding Drum or Stone, press the Collet Release Button, turn the Collet Nut, and pull the stem straight out.

To use grinder with flexible cable:

1. Slot the Collet into the end of the Flexible Cable.
2. Fit the Collet Nut over the Collet and screw into place by pushing in and turning at the same time.
3. Insert the Collet Locking Key into the hole on the side of the Flexible Cable. Push the stem of the Grinding Drum or the Grinding Stone into the collet. Turn the Collet Nut to lock the stem in place.
4. To release the stem of the Grinding Drum or Stone, re-insert the Collet Locking Key, turn the Collet Nut and pull the stem straight out.

Precautions:

- Always wear safety glasses when operating nail grinder
- Do not wear loose clothing or jewelry that can be caught in moving parts
- Do not touch anything but pet's nail with the tool while it is in use
- Do not allow animal to reach or lick the grinder during operation
- Do not use under wet conditions or immerse in liquid
- Use only with parts and accessories listed in this manual
- Make sure grinding attachments are secured in place before use
- Periodically check tool for wear or damage. Do not operate if damaged.
- Do not attempt to repair unit. Contact the PetEdge Service Center at 800-638-5754Z

Maintenance:

- Brush or blow off dust and debris from grinder after use
- Use only a soft cloth to wipe off housing. Never immerse grinder or cord in water
- Replace sanding bands and grinding attachments when blunt or worn
- Periodically check adapter cord and grinder for damage
- Protect cord from heat and/or sharp edges