



**GUARDIAN
GEAR**
LIFETIME GUARANTEE

Sightseer II Pet Car Seat

1. Remove all pieces from the carrying bag.



2. Pop open the seat to form a box-shape.



3. Hold the interior collar clip on the side of the seat to keep it accessible when you insert the included board mat. To insert the mat, open it into a "U" shape and place it into the seat, making sure the Velcro® attaches to the bottom and the left and right sides to retain its shape.



4. Attach the Sherpa lining to the car seat, using the Velcro® tabs. Make sure to feed the D-rings through the slots in the Sherpa lining so they don't become lost under the lining.

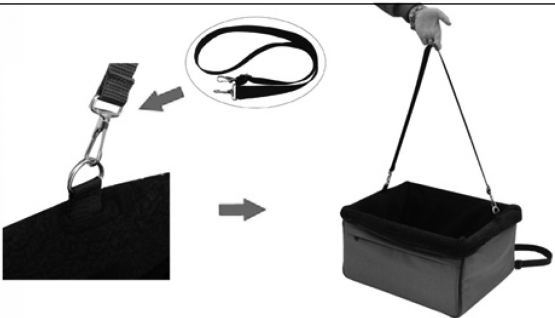

5. Connect the carrying strap to the car seat by clipping the strap to the D-ring on each side of the top.

6. Connect the back strap to the car seat by clipping the strap to the D-ring on each side of the back panel.



7. Attach the car seat to your vehicle's front seat by draping the carrying strap over the seat headrest and clipping the other strap around the back of the car seat.

CARE INSTRUCTIONS:

Wipe fabric clean with a damp cloth using a mild soap and water. Let air dry. Store in a clean, dry place.

Use Instructions: PLEASE READ THESE INSTRUCTIONS CAREFULLY

Designed for use with pets only. Recommended for use with one pet only. Do not overload Sightseer II Car Seat. Maximum weight of pet should not exceed weight capacity. Use of a safety harness or similar restraint is recommended. Do not leave pet unsupervised.

LIMITED WARRANTY

This Guardian Gear® Sightseer II Warranty covers any defects in parts, materials, and workmanship. Any Guardian Gear® product that is determined to be defective in material or workmanship will be replaced without cost to the purchaser for parts or labor. Shipping charges are not included in warranty returns. Please contact PetEdge Customer Service at 1-800-638-5754 regarding any defective product. PetEdge will not be liable under this warranty for any defect, failure or malfunction of this product caused by normal wear, abuse, misuse, unauthorized adjustments or repairs. PetEdge will not be liable for any incidental or consequential damages of any type. Warranty is void if product has been modified in any manner, repaired by anyone other than PetEdge or has been subject to unreasonable use. Warranty is valid in the United States.

Date Purchased: _____ Model #: _____